



167 Guildford Road GUILDFORD NSW

6 3 2

Offering an opportunity to acquire two dwellings on one 752.5 sqm parcel, this house and granny flat duo have each been flawlessly maintained and presented to offer a lifestyle of ease and comfort. The primary residence unfolds over a practical four-bedroom layout, whilst the detached granny flat enjoys an open two-bedroom setting. The property is located within minutes walk of Guildford's diverse shopping hub and Guildford Station.

Type : House
Land Size : 752.5 sqm
View : <https://www.instaproperty.com.au/8391841>

Featuring:

Front House:

:: Four generous-sized bedrooms, one with walk-in robe



Kien Hoang
0434575425

[For full version visit the website](https://www.instaproperty.com.au)

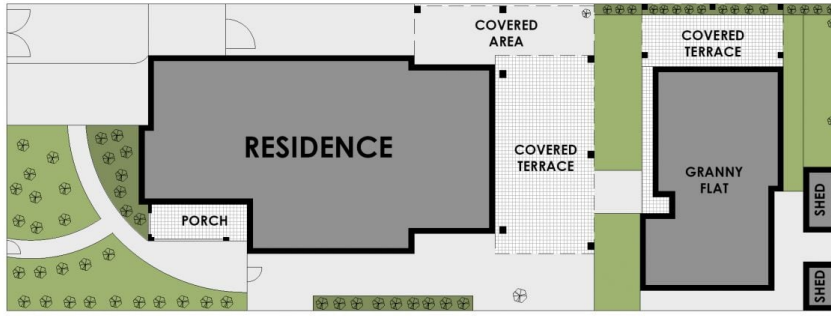

SITE PLAN



FLOOR PLAN



GRANNY FLAT



167 Guildford Road, Guildford

WARNING: DISCLAIMER This information is not to be relied upon. It is strictly used for marketing and illustration purposes only. All measurements are approximate. Not to scale. No liability accepted. You must rely on your own inquiries and seek advice from your solicitor. Floor plan by cnkplan@cnkplan.com.au/ www.cnkplan.com.au