



29 Wallace Street SEFTON NSW

4 2 2

An architecture designed to impress, this refined residence is an absolute masterpiece, quality built with full brick construction and impeccably appointed to showcase an exemplary lifestyle sanctuary. built with Italian Nero brick has more thermal mass which helps keep the house warmer in the winter and cooler by the summer which increases the energy efficiency of the house and saves on bills.

Its elegant interiors unveil a selection of lounging and gathering zones, beautifully enhanced with an open-concept kitchen, living, and dining area that is the social hub everyone will enjoy gathering time together. The

Type : House
Land Size : 628 sqm
View : <https://www.instaproperty.com.au/8391859>



Kien Hoang
0434575425



Iris Ngo
02 7202 2299

[For full version visit the website](https://www.instaproperty.com.au)

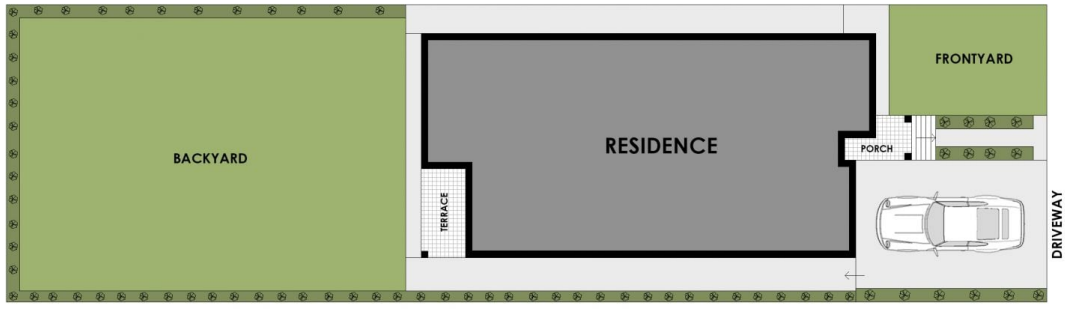

SITE PLAN



FLOOR PLAN

29 Wallace Street, Sefton

WARNING: DISCLAIMER This information is not to be relied upon. It is strictly used for marketing and illustration purposes only. All measurements are approximate. Not to scale. No liability accepted. You must rely on your own inquiries and seek advice from your solicitor. Floor plan by cnkplan@cnkplan.com.au / www.cnkplan.com.au

